



PARKSIDE
YAMBA

Coral



Artist's impression. Neighbouring houses not shown



2

1

2

2

Downsize in luxury

The Coral oozes sophistication with touches of luxury featured throughout the design. Cook up a storm in the chef's kitchen complete with quality appliances and walk-in pantry. Relax in the master suite featuring a walk-in robe and ensuite. Host guests in the second bedroom with separate bathroom and enjoy the flexibility of space with a multi-purpose room, internal laundry, and double garage.

- Chef's kitchen
- Master with WIR and ensuite
- Guest bedroom and multi-purpose room
- Outdoor covered alfresco
- Double garage

Artist's render



Artist's render



Coral

- 1 Living
- 2 Dining
- 3 Kitchen
- 4 Bedroom 1
- 5 Ensuite
- 6 Bedroom 2
- 7 Bathroom
- 8 Alfresco
- 9 Double Garage
- 10 Multi-Purpose Room
- 11 Laundry
- 12 Walk-In Robe
- 13 Walk-In Pantry

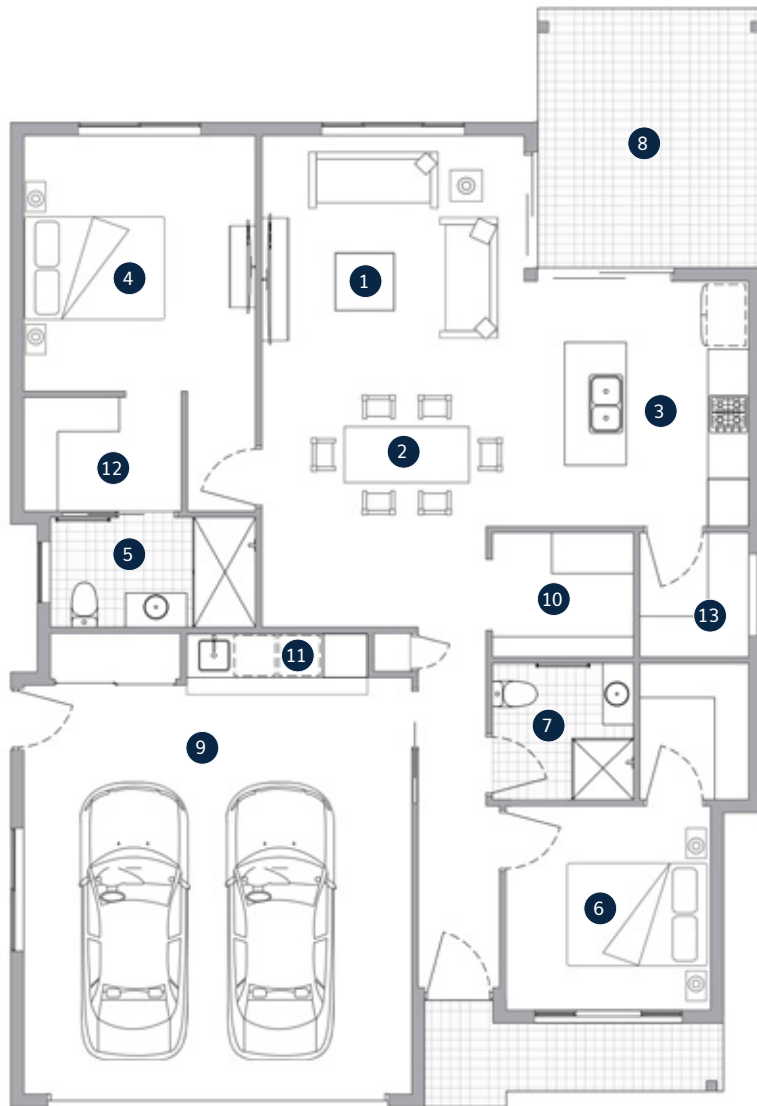

Living	3.6m x 3.9m	Bedroom 2	3.0m x 3.0m
Dining	3.6m x 3.9m	Bathroom	2.0m x 2.1m
Kitchen	3.6m x 3.3m	Alfresco	4.3m x 3.8m
Bedroom 1	3.8m x 3.4m	Double Garage	6.0m x 5.7m
Ensuite	1.6m x 3.0m	Multi-Purpose Room	1.9m x 2.0m
Walk-In Robe	1.7m x 2.3m		



*The facade renders and floorplans are provided for illustrative purposes only. It may contain upgraded items/finishes not included as standard. For detailed home pricing, please talk to a sales consultant. All efforts have been made to ensure accuracy of this brochure at time of print.

A new way of living.

HOMETOWN AUSTRALIA
COMMUNITIES