



Artist's impression. Neighbouring houses not shown



2



1



2



2

A spacious and stylish design

Driftwood is a beautiful home offering a spacious and stylish design. Enjoy the large kitchen with plenty of bench space, walk-in pantry and breakfast bar overlooking the open plan dining and living room with sliding doors to the outdoor alfresco. The master features an oversized walk-in robe and ensuite. Enjoy flexibility with a guest bedroom, separate bathroom, multipurpose room, and double garage.

- Modern kitchen with walk-in pantry
- Master with WIR and ensuite
- Guest bedroom and multi-purpose room
- Outdoor covered alfresco
- Double garage

Artist's render - Clubhouse



Artist's render - Pool

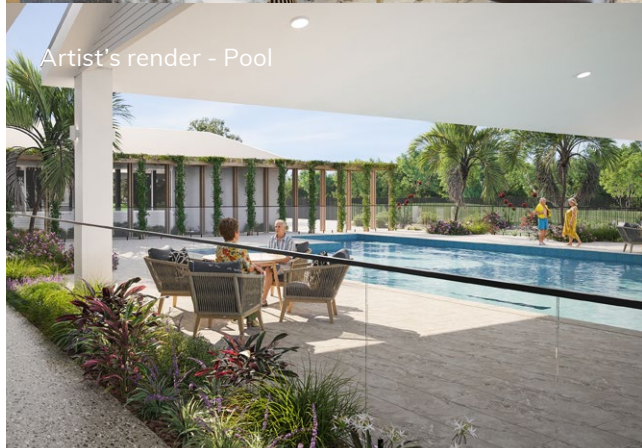

Driftwood

- 1 Living
- 2 Dining
- 3 Kitchen
- 4 Bedroom 1
- 5 Ensuite
- 6 Bedroom 2
- 7 Bathroom
- 8 Alfresco
- 9 Double Garage
- 10 Multi-Purpose Room
- 11 Laundry
- 12 Walk-In Robe
- 13 Walk-In Pantry

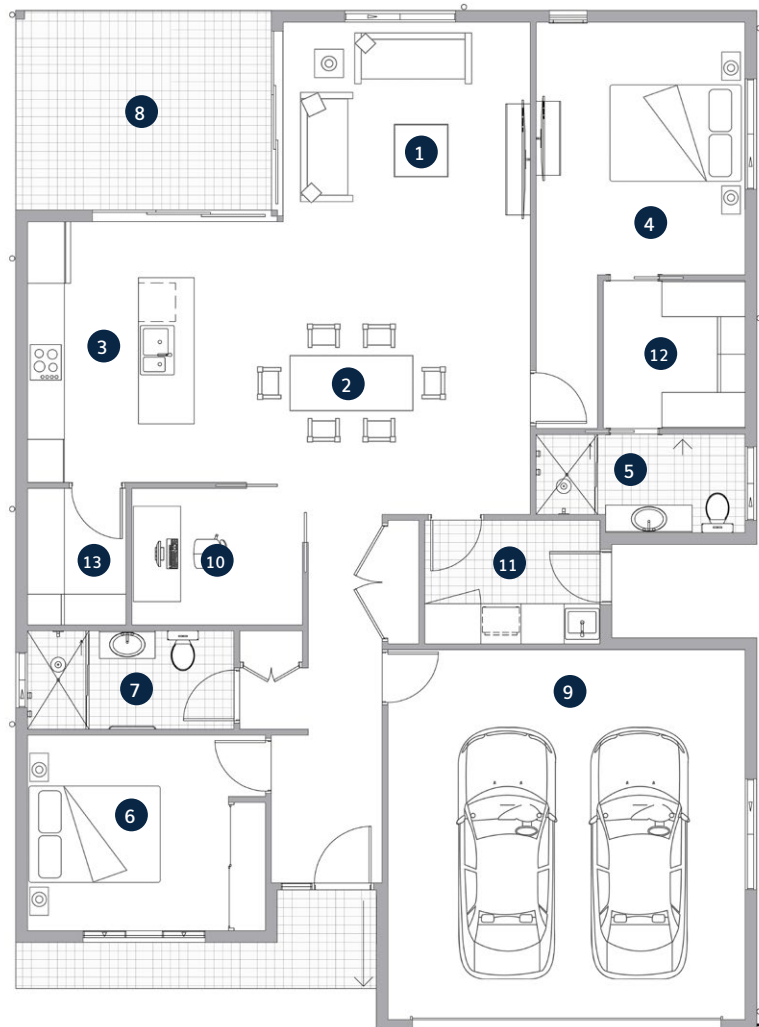

Living	4.0m x 3.7m	Bedroom 2	3.2m x 3.2m
Dining	4.0m x 3.7m	Bathroom	1.6m x 3.4m
Kitchen	4.1m x 4.2m	Alfresco	4.1m x 3.2m
Bedroom 1	3.4m x 4.1m	Double Garage	6.0m x 5.8m
Ensuite	1.6m x 3.4m	Multi-Purpose Room	2.2m x 2.8m
Walk-In Robe	2.4m x 2.3m	Total Area	198.5m²



*The facade renders and floorplans are provided for illustrative purposes only. It may contain upgraded items/finishes not included as standard. For detailed home pricing, please talk to a sales consultant. All efforts have been made to ensure accuracy of this brochure at time of print.

A new way of living.

HOMETOWN AUSTRALIA
COMMUNITIES