



Artist's impression. Neighbouring houses not shown



## Modern, stylish and welcoming

Discover your new home in the modern and stylish Sandpiper design. The chef's kitchen is the heart of the home overlooking the open plan living and dining areas flowing onto the alfresco. Step into the master suite featuring an oversized walk-in robe and modern bathroom. Enjoy flexible living with a guest bedroom, separate bathroom, multi-purpose room, and double car garage.

- Modern kitchen
- Open plan living and dining
- Master with WIR and ensuite
- Guest bedroom and multi-purpose room
- Double garage

Artist's render - Clubhouse



Artist's render - Pool

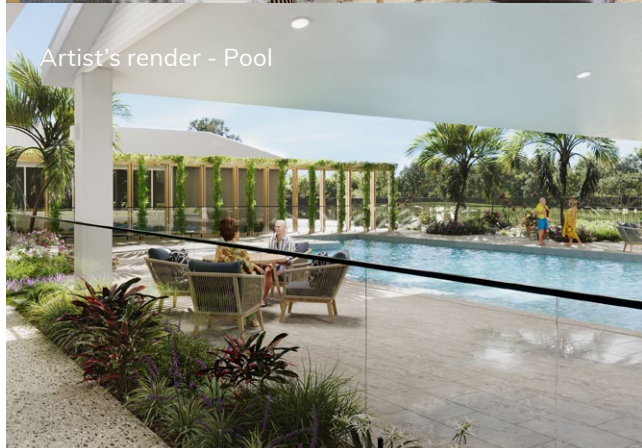

# Sandpiper

- 1 Living
- 2 Dining
- 3 Kitchen
- 4 Bedroom 1
- 5 Ensuite
- 6 Bedroom 2
- 7 Bathroom
- 8 Alfresco
- 9 Double Garage
- 10 Multi-Purpose Room
- 11 Laundry
- 12 Walk-In Robe

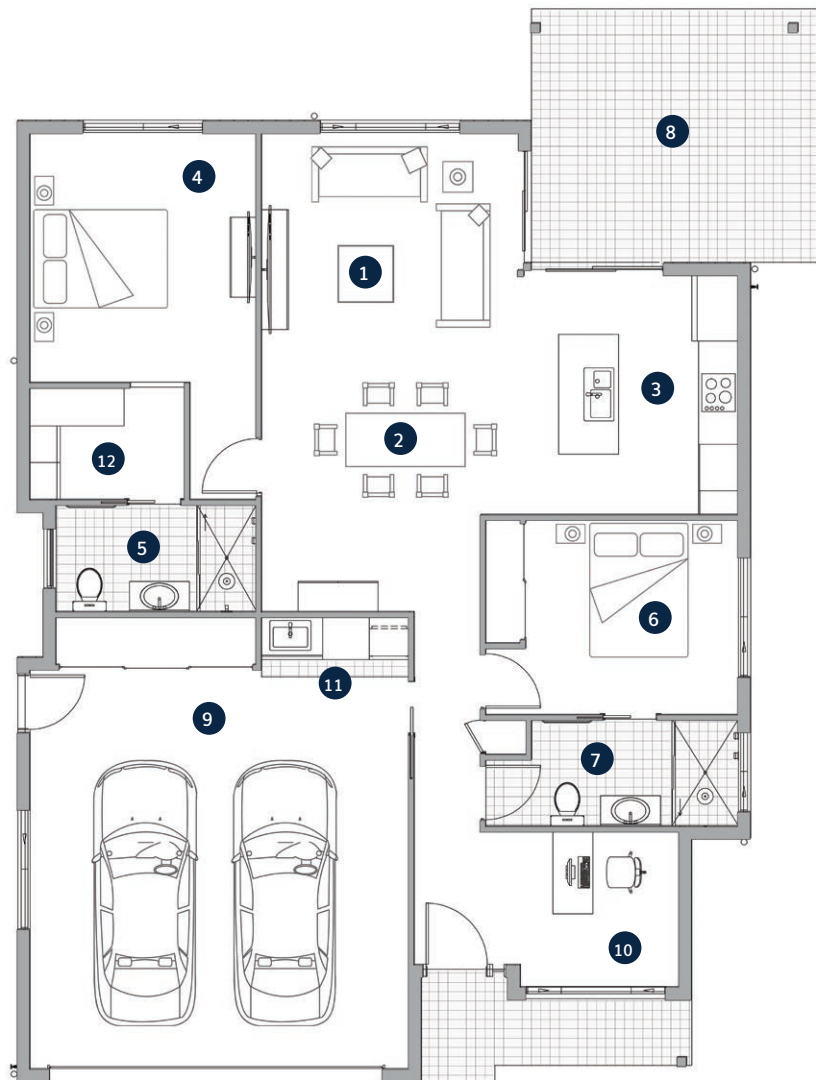

Living	3.6m x 3.9m	Bedroom 2	2.9m x 3.8m
Dining	3.6m x 3.9m	Bathroom	1.6m x 3.8m
Kitchen	3.6m x 3.1m	Alfresco	4.2m x 3.8m
Bedroom 1	3.8m x 3.4m	Double Garage	6.0m x 5.7m
Ensuite	1.6m x 3.0m	Multi-Purpose Room	2.0m x 2.4m
Walk-In Robe	1.7m x 2.3m	<b>Total Area</b>	<b>193.2m<sup>2</sup></b>



\*The facade renders and floorplans are provided for illustrative purposes only. It may contain upgraded items/finishes not included as standard. For detailed home pricing, please talk to a sales consultant. All efforts have been made to ensure accuracy of this brochure at time of print.

A new way of living.

**HOMETOWN AUSTRALIA**  
COMMUNITIES