



Artist's impression. Neighbouring houses not shown



The best in indoor/outdoor living

At the heart of the home is the outdoor alfresco capturing the natural light and the beautiful fresh breeze. With doors opening onto the modern kitchen, dining and living areas it sets the scene for the best in indoor-outdoor living. Retreat to the master suite with walk-in robe and ensuite, host guests in the second bedroom with separate bathroom and enjoy extra space with a study.

- Modern kitchen
- Master with WIR and ensuite
- Guest bedroom and study
- Outdoor covered alfresco
- Double garage

Artist's render - Clubhouse

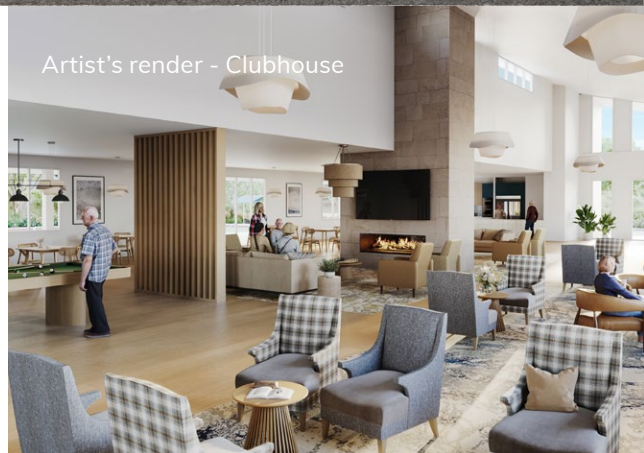

Artist's render - Pool

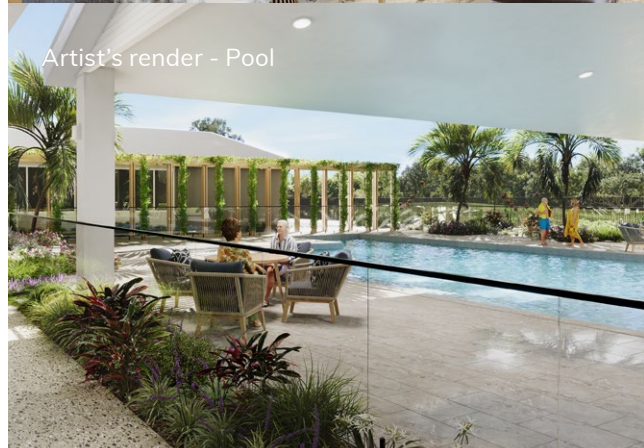

Saltbush

- 1 Living
- 2 Dining
- 3 Kitchen
- 4 Bedroom 1
- 5 Ensuite
- 6 Bedroom 2
- 7 Bathroom
- 8 Alfresco
- 9 Double Garage
- 10 Multi-Purpose Room
- 11 Laundry
- 12 Walk-In Robe

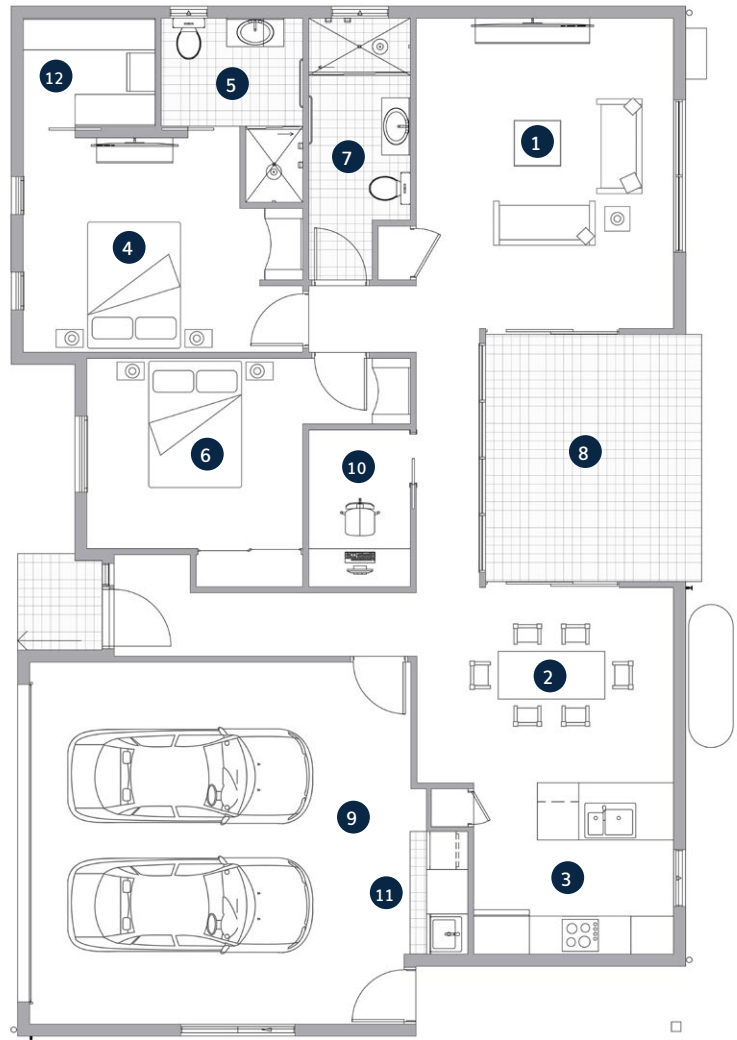

Living	4.1m x 4.9m
Dining	4.0m x 3.1m
Kitchen	3.1m x 2.7m
Bedroom 1	4.5m x 4.4m
Ensuite	1.7m x 2.2m
Walk-In Robe	1.7m x 2.1m

Bedroom 2	3.0m x 3.4m
Bathroom	1.6m x 3.2m
Alfresco	3.4m x 3.9m
Double Garage	5.7m x 6.0m
Multi-Purpose Room	1.6m x 2.5m
Total Area	219.8m²



*The facade renders and floorplans are provided for illustrative purposes only. It may contain upgraded items/finishes not included as standard. For detailed home pricing, please talk to a sales consultant. All efforts have been made to ensure accuracy of this brochure at time of print.

A new way of living.

HOMETOWN AUSTRALIA
COMMUNITIES